

## NEMA 4 & 4X REPLACEMENT HEADS AND TERMINAL BLOCKS

### CAST ALUMINUM – gasketed screw cover

NEMA 4 with gasketed screw cover and stainless steel chain;  
4-post ceramic terminal block included. For epoxy-coated, NEMA  
4X, add suffix-E to part#. (e.g., PH01E)

Ordering Code	Process Conn.	Conduit Conn.
PH01	1/2"	1/2"
PH02	1/2"	3/4"
PH03	3/4"	3/4"

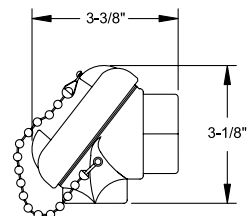

PH01 - PH06

### CAST IRON – NEMA 4, gasketed screw cover

NEMA 4 with gasketed screw cover and stainless steel chain;  
4-post ceramic terminal block included. For epoxy-coated, NEMA  
4X, add suffix-E to part #. (e.g., PH04E)

Ordering Code	Process Conn.	Conduit Conn.
PH04	1/2"	1/2"
PH05	1/2"	3/4"
PH06	3/4"	3/4"

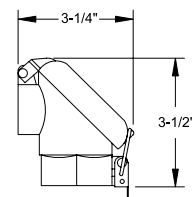

PH45

### CAST ALUMINUM – flip-top cover

NEMA 4 with flip-top cover and latching closure, 4-post ceramic  
terminal block included.

Ordering Code	Process Conn.	Conduit Conn.
PH45	1/2"	3/4"

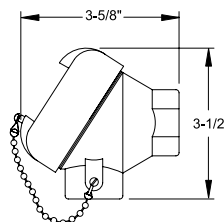

PH47

### 316 STAINLESS STEEL – NEMA 4X, gasketed screw cover

NEMA 4X with gasketed screw cover and stainless steel chain;  
4-post ceramic terminal block included.

Ordering Code	Process Conn.	Conduit Conn.
PH47	1/2"	3/4"

### BLACK POLYPROPYLENE – NEMA 4, gasketed screw cover

NEMA 4 with gasketed screw cover, 4-post ceramic terminal block  
included.

Ordering Code	Process Conn.	Conduit Conn.
PH23	1/2"	3/4"

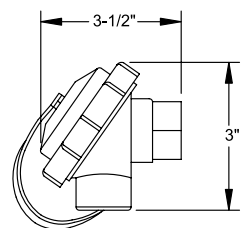

PH23 - PH24

### WHITE POLYPROPYLENE – NEMA 4, gasketed screw cover

NEMA 4 with gasketed screw cover and stainless steel chain;  
4-post ceramic terminal block included.

Ordering Code	Process Conn.	Conduit Conn.
PH24	1/2"	3/4"

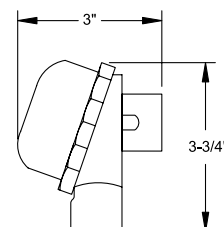

PH26

### NYLON – NEMA 4, gasketed screw cover

Gasketed screw cover, 4-post ceramic terminal block included.

Ordering Code	Process Conn.	Conduit Conn.
PH26	1/2"	1/2"

### CERAMIC TERMINAL BLOCK REPLACEMENTS

For NEMA 4 heads, brass terminals

Ordering Code	No. of Terminals	Max. Wire Size
PH39	2	8 AWG.
PH40	3	8 AWG.
PH41	4	8 AWG.
PH42	6	14 AWG.

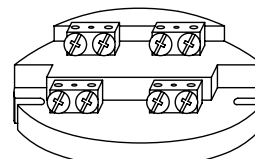

PH41

## EXPLOSION-PROOF REPLACEMENT HEADS AND TERMINAL BLOCKS

### CAST ALUMINUM – FM/CSA approved

FM/CSA approved for Class I, Div. 1, Groups B, C, D; Class II, Groups E, F, G; gasketed screw cover and stainless steel chain; 6-post ceramic terminal block included. For epoxy-coated, add suffix-E to part #. (e.g., PH50E)

Ordering Code	Process Conn.	Conduit Conn.
PH50	1/2"	1/2"
PH51	1/2"	3/4"
PH52	3/4"	3/4"

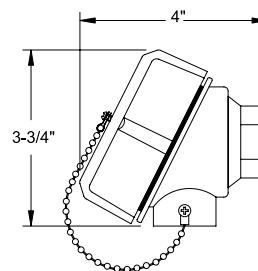

PH50-52,  
PH56-57

### STAINLESS STEEL – FM/CSA approved

FM/CSA approved for Class I, Div. 1, Groups B, C, D; Class II, Groups E, F, G; gasketed screw cover and stainless steel chain; 6-post ceramic terminal block included.

Ordering Code	Process Conn.	Conduit Conn.
PH56	1/2"	1/2"
PH57	1/2"	3/4"

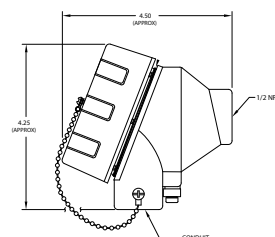

PH53

### CAST ALUMINUM – ATEX approved

ATEX approved for EEx d IIC, gasketed screw cover and stainless steel chain; 3-post ceramic terminal block included.

Ordering Code	Process Conn.	Conduit Conn.
PH53	1/2"	3/4"

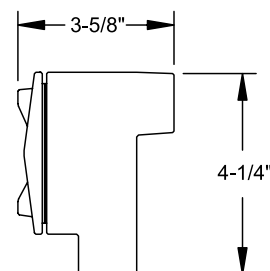

PH17-19

### CAST ALUMINUM – UL/CSA approved

UL/CSA approved for Class I, Div. 1, Groups C, D; Class II, Groups E, F, G; screw cover; 4-post plastic terminal strip included. For epoxy-coated, add suffix-E to part #. (e.g., PH17E)

Ordering Code	Process Conn.	Conduit Conn.
PH17	1/2"	1/2"
PH18	1/2"	3/4"
PH19	3/4"	3/4"

### PLASTIC TERMINAL STRIP REPLACEMENTS

For explosion-proof heads (PH17-PH22), brass terminals

Ordering Code	No. of Terminals	Length of Strip
PH43-4	4	2.16"
PH43-6	6	2.91"

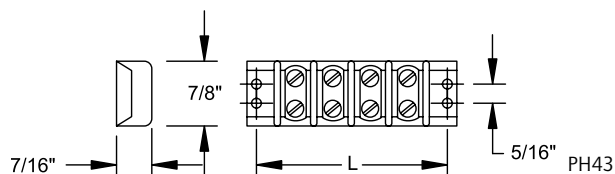

PH43

### CERAMIC TERMINAL BLOCK REPLACEMENTS

For explosion-proof heads (PH50-PH52), brass terminals

Ordering Code	No. of Terminals	Max. Wire Size
PH48	3	8 AWG.
PH49	6	14 AWG.

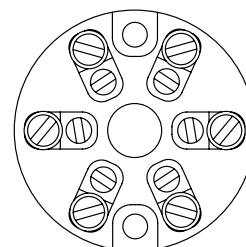

PH49

## PARTS TO CONNECT TO WIRING OR THE PROCESS

COMPRESSION FITTINGS			
For 1/8" diameter sheath			
Part Number	NPT	Body/Nut	Ferrule
<b>PF38</b>	1/8"	304 stst	304 stst
<b>PF39</b>	1/8"	304 stst	Teflon®
<b>PF40</b>	1/4"	304 stst	304 stst
<b>PF41</b>	1/4"	304 stst	Teflon®
For 3/16" diameter sheath			
<b>PF52</b>	1/8"	304 stst	304 stst
<b>PF53</b>	1/8"	304 stst	Teflon®
<b>PF54</b>	1/8"	Brass	Brass
<b>PF55</b>	1/4"	304 stst	304 stst
<b>PF56</b>	1/4"	304 stst	Teflon®
<b>PF59</b>	1/2"	304 stst	304 stst
<b>PF60</b>	1/2"	304 stst	Teflon®
For 1/4" diameter sheath			
<b>PF63</b>	1/8"	304 stst	304 stst
<b>PF65</b>	1/4"	304 stst	304 stst
<b>PF66</b>	1/4"	304 stst	Teflon®
<b>PF67</b>	1/4"	Teflon®	Teflon®
<b>PF68</b>	1/4"	Brass	Brass
<b>PF73</b>	1/2"	304 stst	304 stst
<b>PF74</b>	1/2"	304 stst	Teflon®
<b>PF75</b>	1/2"	Brass	Brass
<b>PF76</b>	1/2"	Teflon®	Teflon®

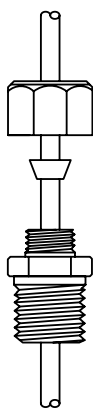

PF38 to PF75

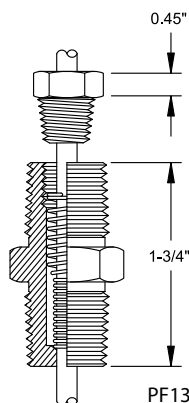

PF13 to PF18

SPRING-LOADED FITTINGS			
Standard, Non-sealed			
Part Number	Process Conn.	Conduit Conn.	Sensor Diameter
<b>PF13</b>	1/2" NPT	1/2" NPT	3/16"
<b>PF14</b>	1/2" NPT	1/2" NPT	1/4"
<b>PF17</b>	3/4" NPT	3/4" NPT	3/16"
<b>PF18</b>	3/4" NPT	3/4" NPT	1/4"
O-Ring Sealed*			
<b>PF21</b>	1/2" NPT	1/2" NPT	3/16"
<b>PF22</b>	1/2" NPT	1/2" NPT	1/4"
<b>PF25</b>	3/4" NPT	3/4" NPT	3/16"
<b>PF26</b>	3/4" NPT	3/4" NPT	1/4"
Notes:			
1. Maximum pressure rating 15 psi			
2. Buna N O-ring rated for -23 to 93°C (-10 to 200°F)			

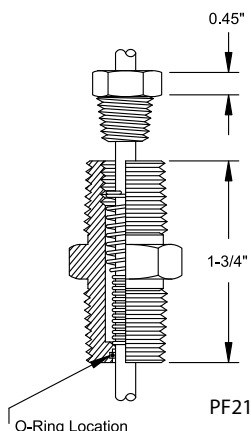

PF21 to PF26

PLUGS AND JACKS	
(Note: specify J, K, E or T calibration. e.g., PT05-J)	
<b>PT05</b>	Standard plug, rated to 177°C (350°F)
<b>PT06</b>	Standard jack, rated to 177°C (350°F)
<b>PT07</b>	High Temp. plug, rated to 260° (500°F)
<b>PT08</b>	High Temp. jack, rated to 260° (500°F)
<b>PT09</b>	Miniature plug, rated to 177°C (350°F)
<b>PT10</b>	Miniature jack, rated to 177°C (350°F)
<b>PA9</b>	Rubber boot for use with PT05/PT06
<b>PA10</b>	Cable clamp for PT05 to PT08
<b>PA11</b>	Neoprene bushing for use with PA10 to prevent wire abrasion

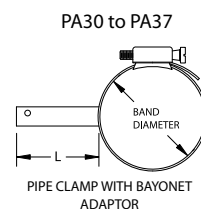
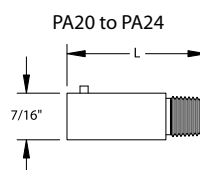
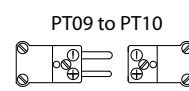
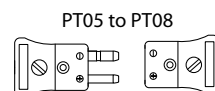

BAYONET ADAPTERS (PLATED STEEL)		
Part Number	Thread Size	Length (L)
<b>PA20</b>	1/8" - 27 NPT	7/8"
<b>PA21</b>	1/8" - 27 NPT	1"
<b>PA22</b>	1/8" - 27 NPT	1-1/2"
<b>PA23</b>	1/8" - 27 NPT	2"
<b>PA24</b>	1/8" - 27 NPT	2-1/2"
PIPE CLAMP AND BAYONET ADAPTERS		
Part Number	Band Diameter	Adapter Length (L)
<b>PA30</b>	1-1/4" to 2-1/4"	1"
<b>PA31</b>	1-1/4" to 2-1/4"	2"
<b>PA32</b>	2-1/4" to 3-1/4"	1"
<b>PA33</b>	2-1/4" to 3-1/4"	2"
<b>PA34</b>	3-1/4" to 4-1/4"	1"
<b>PA35</b>	3-1/4" to 4-1/4"	2"
<b>PA36</b>	4-1/4" to 5"	1"
<b>PA37</b>	4-1/4" to 5"	2"